



## Concealed Duct High Static Pressure Type

### Design flexibility

- Compatible with external static pressures up to 250 Pa.
- Internal Drain pump: lift up to 850mm (except 22,4 kw & 20,0 kw)

### Construction characteristics

Three-phase-switchable static pressure.

The flexible duct is accessible.

Easy service and installation.

Inspection hole enables easy access and maintenance.

**MMD-AP\*\*\*6HP1-E**  
**MMD-AP\*\*\*4H1-E**

## Technical specifications

Model name		MMD-	AP0186HP1-E	AP0246HP1-E	AP0276HP1-E	AP0366HP1-E	AP0486HP1-E	AP0566HP1-E	AP0726H1-E	AP0966H1-E
Cooling / Heating capacity *(1)	(kW)		5.6/6.3	7.1/8.0	8.0/9.0	11.2/12.5	14.0/16.0	16.0/18.0	22.4/25.0	28.0/31.5
Electrical characteristics	Power requirements		1-phase 50 Hz 230 V (220-240 V) / 1-phase 60 Hz 220 V (Separate power supply for indoor units required)							
	Power consumption	(kW)	0.085	0.115	0.198	0.230	0.290	0.540	0.790	
Dimensions	Height	(mm)	298						448	
	Width	(mm)	1000			1400			1400	
	Depth	(mm)	750						900	
Weight	(kg)		34			43			97	
Fan unit	Standard air flow (Med / Low)	(m <sup>3</sup> /h)	800 (660/550)	1.200 (970/800)		1.920 (1560/1340)	2.100 (1740/1420)	2.400 (2040/1660)	3.800	4.800
	Motor output	(W)	250			350			370X3	
	External static pressure (factory setting)	(Pa)	100						137	
	External static pressure	(Pa)	50-75-125-150-175-200 (7 steps)						50-83-117-<150>-183-217-250	
Connecting pipe	Gas side	(mm)	12.7	15.9			22.2			
	Liquid side	(mm)	6.4	9.5			12.7			
	Drain port	(nominal dia.)	25 (Polyvinyl chloride tube)							
Sound pressure level *(2) (High/Mid/Low)	(dB(A))		37/32/30	38/34/31		41/37/34	42/40/35	45/42/37	44	46
Sound power level (High/Mid/Low)	(dB(A))		60/54/50	60/55/51		62/57/53	65/62/54	68/64/56	69	70

Note 1 : The cooling capacities and electrical characteristics are measured under the conditions specified by JIS B 8615 based on the reference piping. The reference piping consists of 5m of main piping and 2.5 of branch piping connected with 0 meter height.

Note 2 : The sound level are measured in an anechoic chamber in accordance with JIS B 8616.

Normally, the values measured in the actual operating environment become larger than the indicated values due to the effects of external sound.

Note : Rated conditions Cooling : Indoor air temperature 27°C DB/19°C WB, Outdoor air temperature 35°C DB.

Heating : Indoor air temperature 20°C DB, Outdoor air temperature 7°C DB/6°C WB.

MMD-AP0186HP1-E to AP0276HP1-E

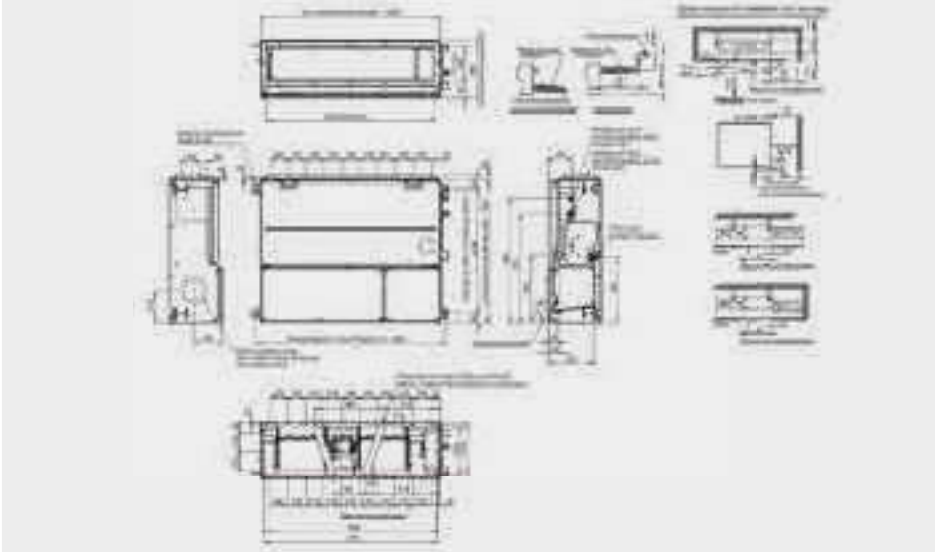

MMD-AP0724H1-E, AP0964H1-E

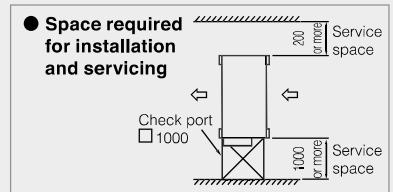
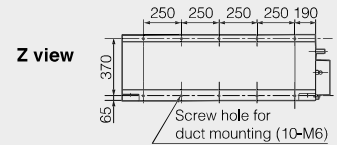
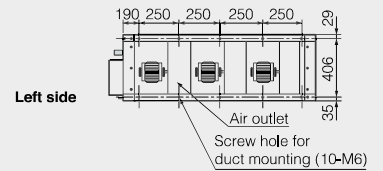
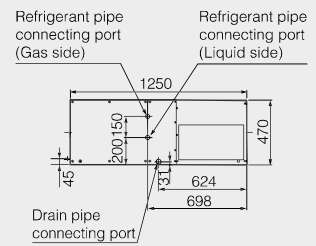
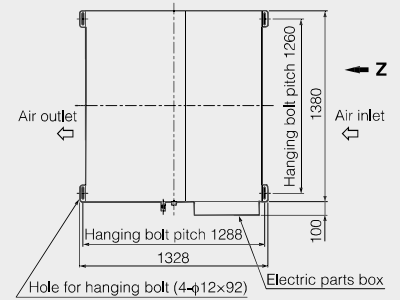

(Unit: mm)

MMD-AP0366HP1-E to AP0566HP1-E

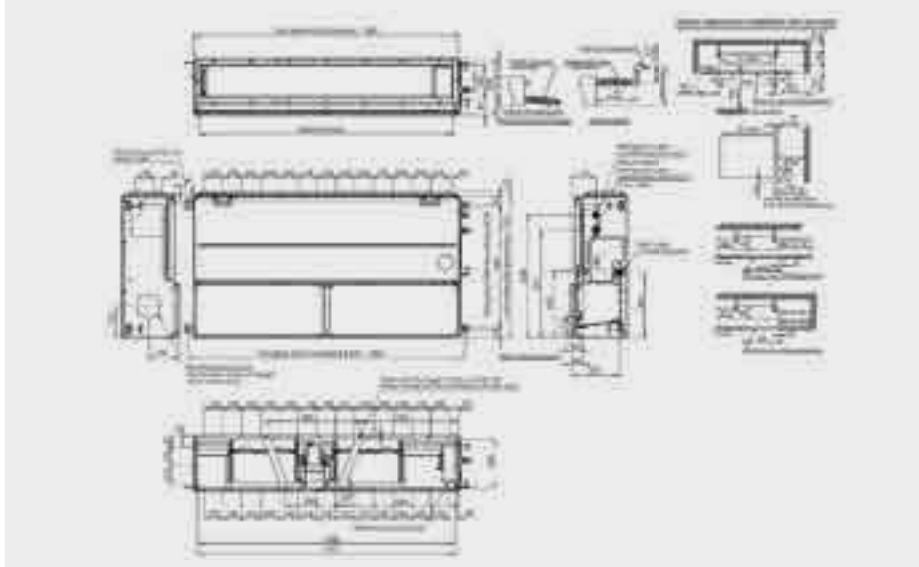

Options

MMD-AP\*\*\*6HP1-E

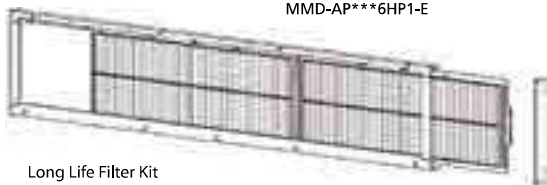

Long Life Filter Kit  
TCB-LK801D-E  
TCB-LK1401D-E

MMD-AP0366HP1-E to AP0566HP1-E

MMD-AP\*\*\*4H1-E

